

Complete this section and turn it in at
the Information Booth in the Welcome Plaza
for a free trading card!

1) Name one part of the African Elephant Crossing exhibit that saves resources and reduces Cleveland Metroparks Zoo's use of fossil fuels, shrinking our ecological footprint and helping elephants.

2) How willing are you to take personal responsibility to decrease your ecological footprint? (CHECK ONE)

_____ Very willing

_____ Somewhat willing

_____ Not so sure I want to do anything

_____ Not willing to change what I do

3) Name one new action you can start taking within the next month, in your private or professional life, to save resources and improve the future for African elephants.

The Zoo is doing it— you can too!

MAKE A DIFFERENCE

- ◆ Change one habit to reduce your ecological footprint and slow changes in our global climate.
- ◆ Ask a friend to join you in reducing your ecological footprint to save elephants.
- ◆ Donate as little as **\$1.00** to African elephant conservation and research projects funded by the Cleveland Zoological Society, monitored by Cleveland Metroparks Zoo conservation and research professionals.

Visit the donation station at African Elephant Crossing to make a donation today!

- ◆ Purchase handicrafts from the Zoo gift shop to support communities in southern African working to prevent elephant poaching.
- ◆ Take a class offered by the Zoo or volunteer to learn more about wildlife and wild places. Go to clemetzoo.com/educate for more information on programs for ages 5 and up.



(216) 661-6500
clemetzoo.com
clevelandzoosociety.org

Cleveland Metroparks Zoo

Making the world better
for elephants—everyday.



AFRICAN
**ELEPHANT
CROSSING**

CLEVELAND METROPARKS ZOO

AFRICAN ELEPHANT CROSSING—Reducing the Zoo's ecological footprint to improve the future for wildlife.

REDUCE YOUR ECOLOGICAL FOOTPRINT

- ◆ Buy locally grown and produced food. Save energy in food production and support our local communities.
- ◆ Take reusable tote bags to the store. Plastic bags are made from petroleum and often end up as litter that can harm wildlife.
- ◆ Carpool, take the bus, or ride your bike whenever possible. Fuel efficient transportation is a great way to curb carbon emissions.
- ◆ Reduce your household waste by recycling, composting, and reusing items. Many landfills are full—where will your trash go?
- ◆ Replace your conventional light bulbs with low energy CFL or LED bulbs. They use less energy and last longer. Recycle your CFL bulbs at the Zoo.

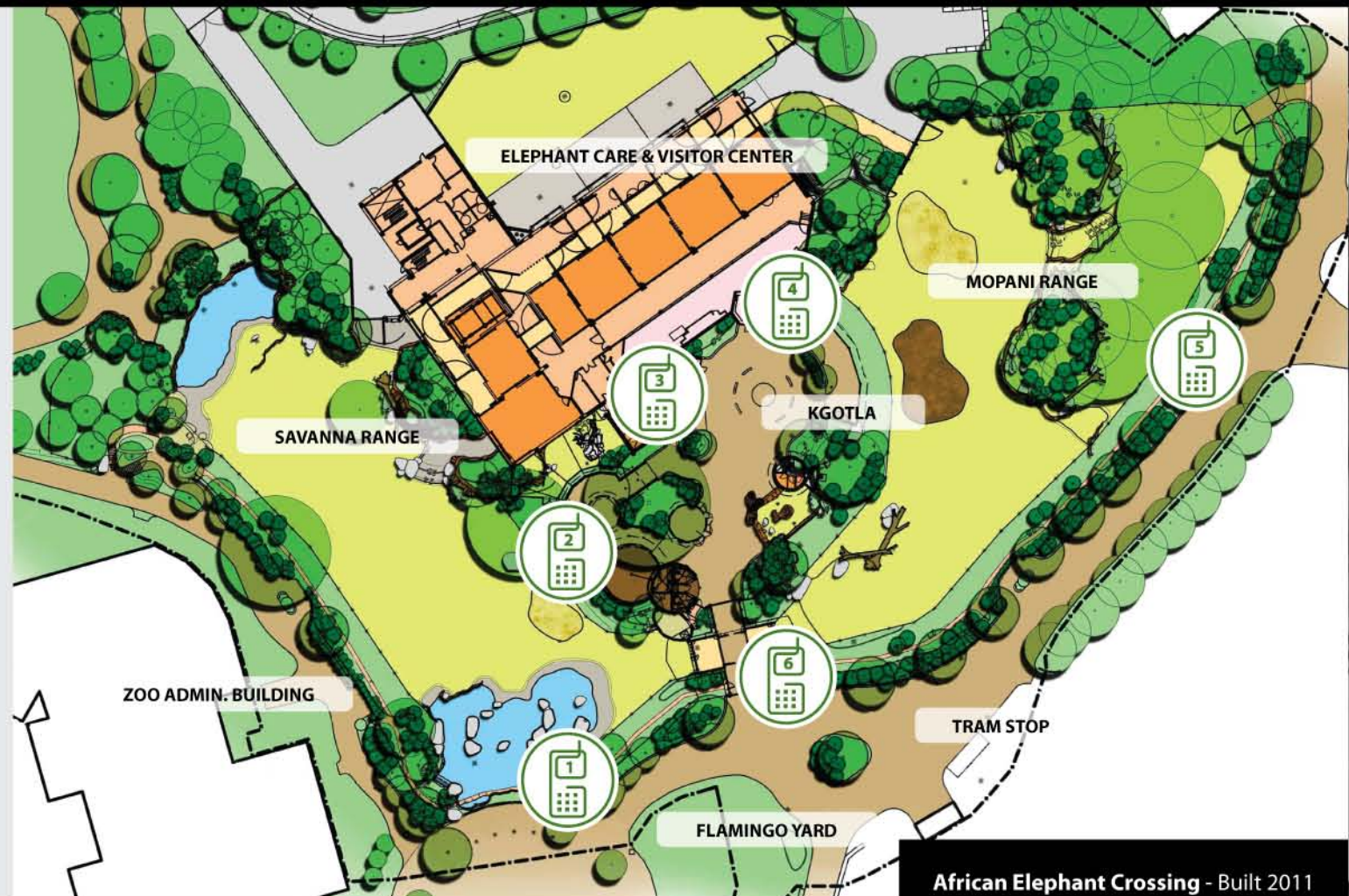

African Elephant Crossing - Built 2011

CELL PHONE AUDIO TOUR

Download the Zoo's iPhone application, or take a cell phone tour by dialing the Guide by Cell number:



- Look for this symbol on signs around key locations at African Elephant Crossing.
- Dial **(216) 453-3962** and enter the listed code to learn about how the Zoo leads in sustainable practices and works to improve the life for African elephants.

THE ZOO REDUCES ITS ECOLOGICAL FOOTPRINT

- 1** - Most water is reused, pumped through a filtration system, purified, and sent back to the pools.
- 2** - Deck materials are made in part from recycled plastic.
- 3** - The air is circulated through the building four times an hour. The most energy efficient heating system available was installed.

4 - Natural skylight vents open and close as needed to maintain a stable air temperature, year round. Heating in the floor is soothing to the elephant's feet and saves energy.

5 - 85% of the trees in the original exhibit were either saved and remain planted in the yards, or used in alternative ways on grounds.

6 - Manual gates at African Elephant Crossing save energy over those powered by electricity.